



PYRAMID

CONSULTANTS | DESIGNERS | CONTRACTORS
DESIGNING SPACES TO LIVE AND PROSPER

About Us



- We are Engineers, Consultants and Contractors with in-house Architectural Services.
- We have an experience of 20 years (including 8 years in the UAE).
- Have completed 2,00,000 sq.ft. of building work, in and around Mysuru ~ including Mercara, Chamarajnagar, Channapatna, Mandya, etc.
- Have work experience of all types of buildings, Residential, Commercial etc.
- We just don't build concrete structures, we build lasting relationships.
- We are associated with some of the leading architects and builders.
- We are one stop solution for all your construction needs.

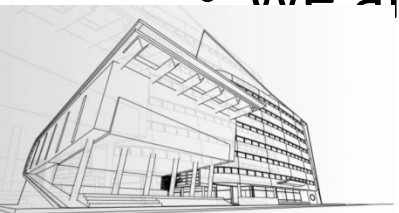

Services



- We
- Plan
- Design
- Estimation
- Elevation
- Valuation
- Interior Design



PROCESS



- Meeting the client
 - Noting requirements
 - Getting details of plot or existing structure
 - Visiting the location for topographic details
 - Discussing the budget
 - Plan
- Elevation
 - Costing
 - Specifications
 - Payment terms
 - Enter the agreement
 - Work starts on site

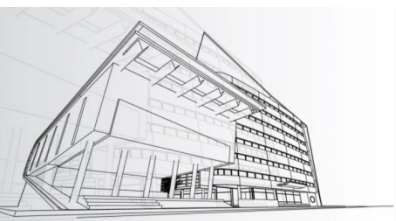

RECENT SUCCESS STORY 1

Client: Rajan of Rajan Electricals @ Mysuru

Challenges: His house was not Vastu compliant.

- Rajan consulted me, and I gave him technical advice as per Vastu requirements.
- He cross verified my suggestions (on Vastu compliance) with a pundit and was doubly impressed with my Vastu proficiency. I went on to do a large scale renovation for his house in 4 months.
- Client was so happy that he gave me 3 projects, the 1st project being in KT Street, which I am currently doing.



RECENT SUCCESS STORY 2

Client: Anil Kumar (Fab India) @ Halladakere, Mysuru.

Challenges: He had a 60 year old building with 3 floors. They wanted to alter ground floor into commercial space. **Nobody knew** whether it was a framed structure or otherwise ~ to proceed.

- Anil heard about me from common friends (also my clients) in KT Street.
- Before me, he had consulted with 4 or 5 Engineers, but he wasn't satisfied.
- It took me 23 days to diagnose and discover that the building was a framed structure.
- We gave structural stability to the building and altered it into a 345 sq.ft. commercial space - while at the same time, assuring the family to live in the 1st floor above. Anil was happy, and gave me another duplex house, which we constructed later.

RECENT SUCCESS STORY 3

Client: Syed Alam (NRI) | father's residence in Mysuru

Challenges: The client's house was originally on the 1st floor. The foundation was very shallow he didn't know how to proceed.

- When we dug up and gave extra pillars.
- It was challenging, but we gave him a 22 ft x 22 ft big hall, without disturbing existing ground floor, they were very happy!
- They referred me to one a cousin, and we built him a beautiful house.



Residence | Pulikeshi Road



Residence | Mandi Mohalla, Mysuru



PROJECTS

Halai Memon Masjid



Residence @ Pulikeshi Road



Commercial Building @ KT Street



Residence @ Udayagiri



Residence @ RAJIVNAGAR



PROJECTS

Completed Foundation Work



CASTING ROOF SLAB



Landscape Design



PARKING LANDSCAPE

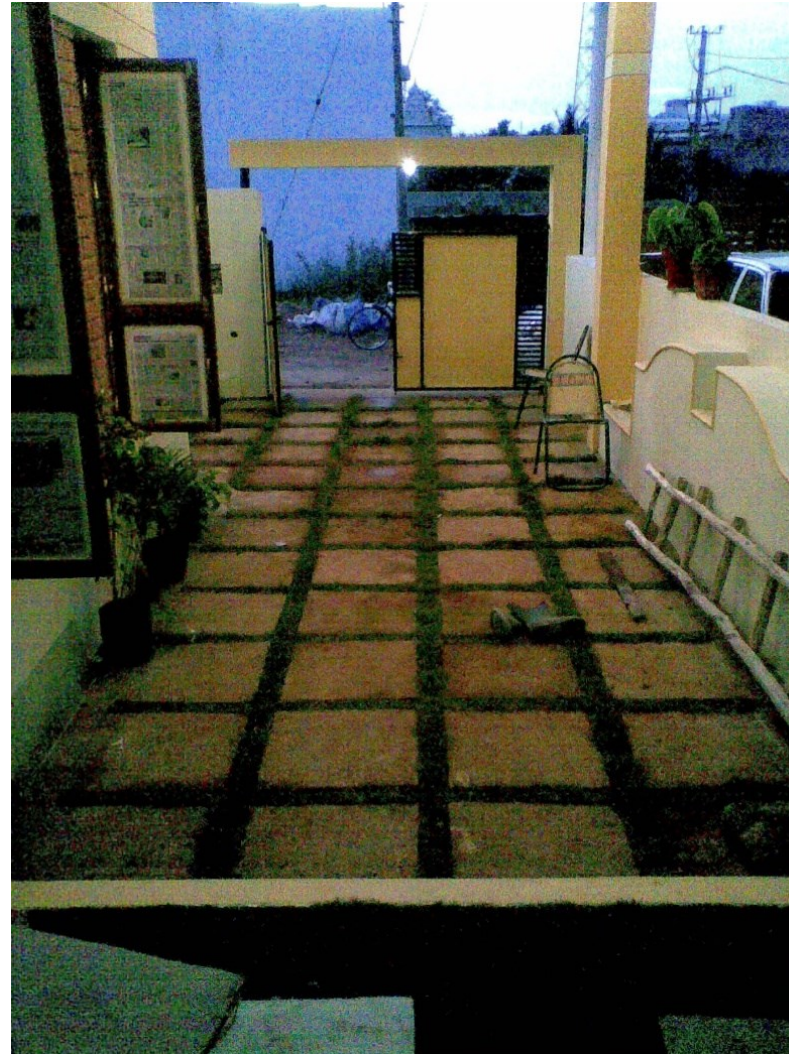

Interior Work



Residence @ RAJIVNAGAR



Post Office Road Jayalakshmipuram



Police Layout Alanahalli

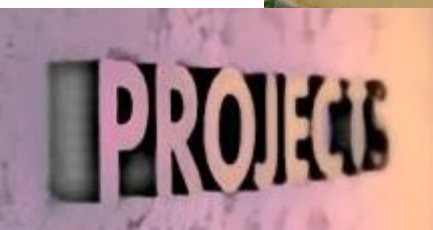

UDAYAGIRI RESIDENCE



PROJECTS

JAYALAKSHMIPURAM



PROJECTS

JAYALAKSHMIPURAM



RAJIVNAGAR RESIDENCE



KT STREET



CHAMRAJAPURAM



UDAYAGIRI RESIDENCE



CONTACT SPHERE

- Elite Products
- Mamta Fashions
- Fab India
- Star Residency
- Jain Hind Traders
- Get Institute
- St. Marinas Convent
- MIT
- Rajan Electricals
- Mataji Electricals And Hardware
- Universal Ceramics
- Hindustan Pipe Center
- RI Estate Agents And Firms
- Individuals



SEEKING

REFERRALS



- My Networking group colleagues
- Their relatives and friends
- Business colleagues
- Govt or Pvt institutions
- Builders
- Anyone planning to built house, commercial establishment, farm house, resort, restaurant.

*Thank
you*

